

A

B

C

D

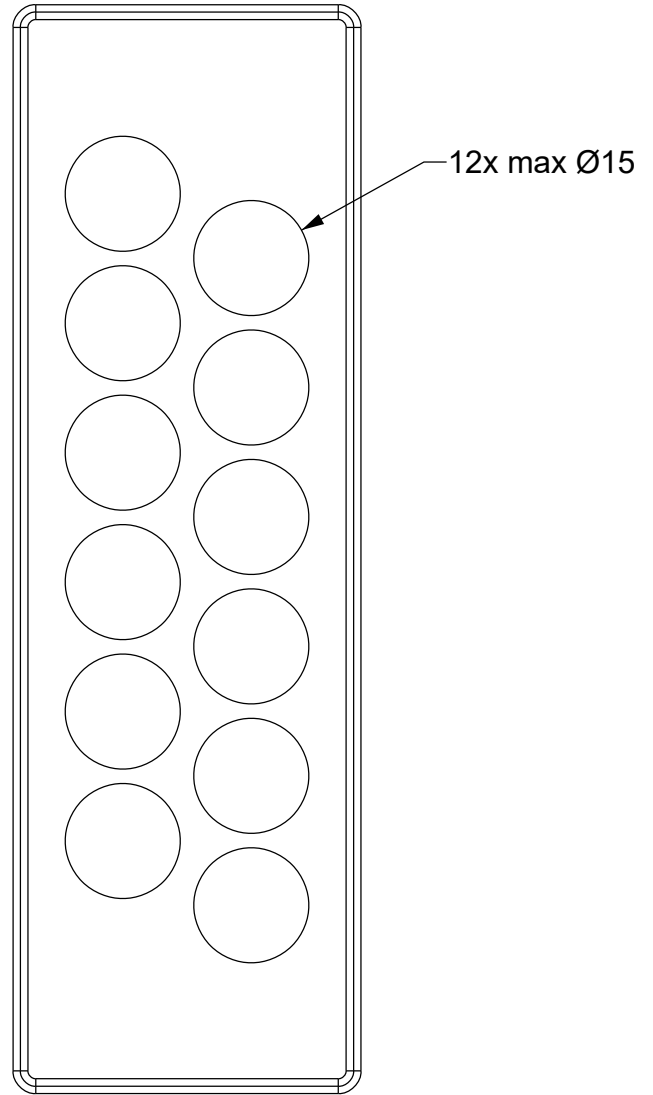
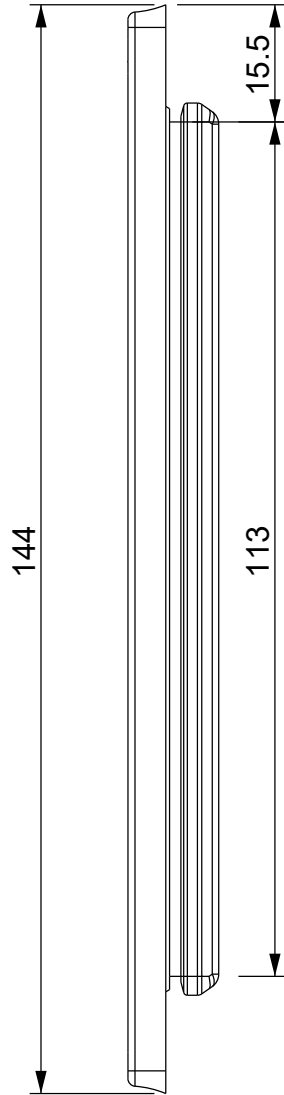
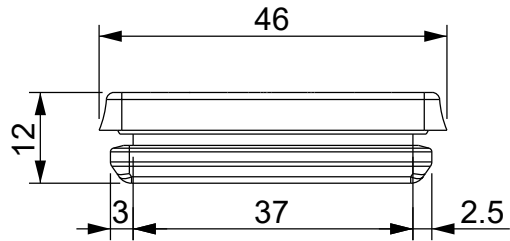
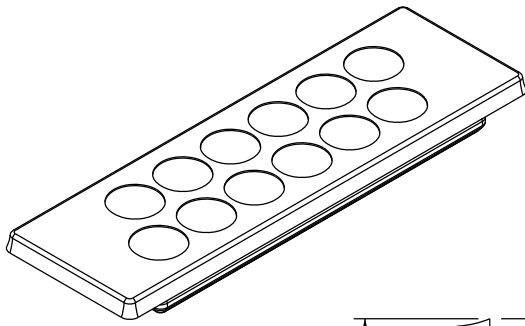

BLACK color version:  
DES PM 24/12B 1732053413

Wall thickness: 1.5 - 2.5 mm

**Flammability:** UL94-V0, self-extinguishing  
**Temperature:** -40°C ... +105°C  
**Properties:** halogen-free, silicone-free  
**Material:** thermoplastic elastomer (TPE)

Recommended cut-out:  
112 x 36 mm

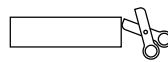

IP65

NEMA  
12

UL TYPE  
12



ECOLAB



Codice / Code

1732052412

Descrizione / Description

DES PM 24/12 G

Rev.  
004

Materiale / Material

TPE

Colore / Color

Grey

Peso / Weight (g)

-

Unità di misura / Measure units

mm

Formato / Format

A4

Scala / Scale

1:1

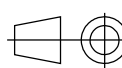

UNI-ISO  
2768-mk



Data / Date  
10/12/2021

Numero foglio / Sheet number

-

Numero progetto / Project number

-

Disegn. / Drawn  
ravezzano@detas.com

Note / Notes

-

QUESTO DISEGNO E LE SUE INFORMAZIONI SONO STRETTAMENTE RISERVATE DI PROPRIETA' DETAS SPA.  
NON UTILIZZARE PER SCOPI DIVERSI DA QUELLI PER CUI SONO STATE FORNITE. DO NOT SCALE DRAWING.

A

B

C

D

A

B

C

D

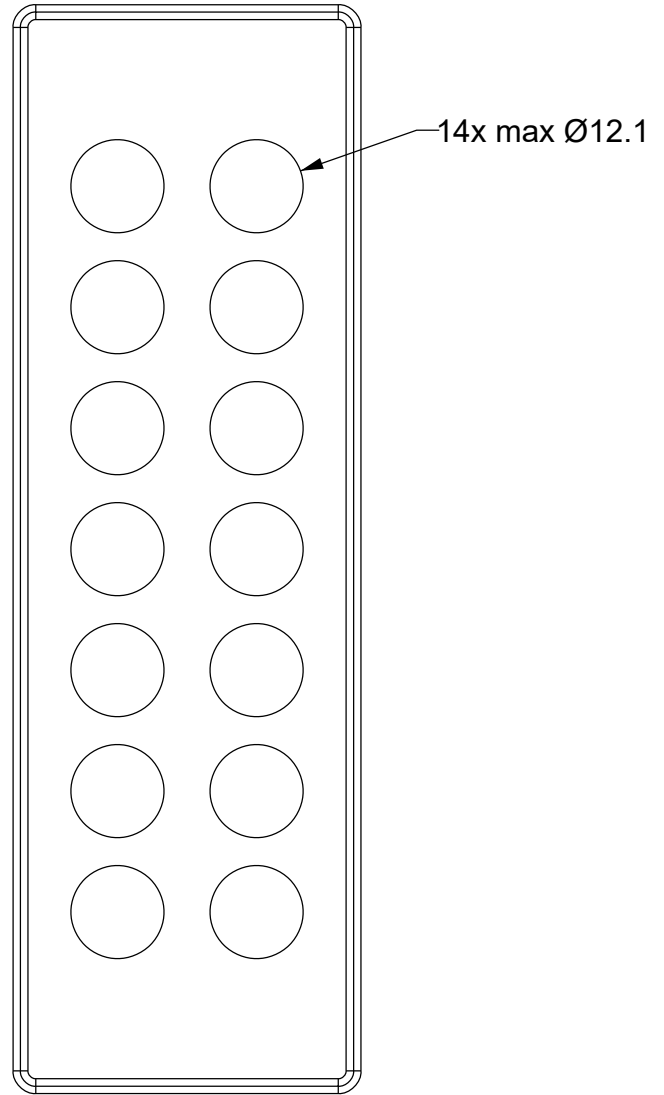
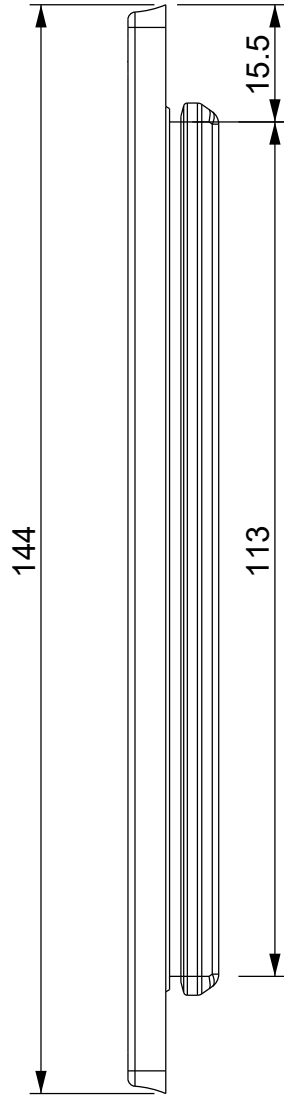
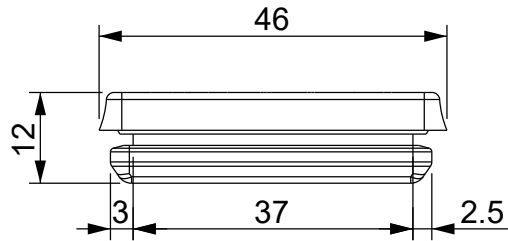
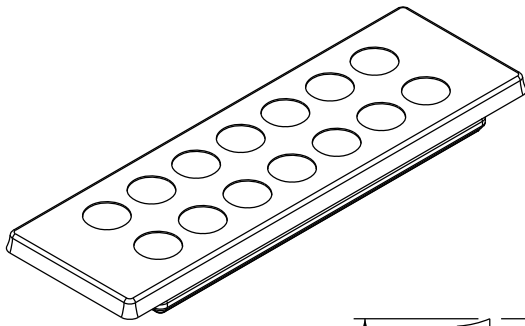

BLACK color version:  
DES PM 24/14B 1732053415

Wall thickness: 1.5 - 2.5 mm

**Flammability:** UL94-V0, self-extinguishing  
**Temperature:** -40°C ... +105°C  
**Properties:** halogen-free, silicone-free  
**Material:** thermoplastic elastomer (TPE)

Recommended cut-out:  
112 x 36 mm

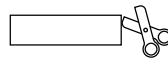

IP65

NEMA  
12

UL TYPE  
12



UL94-V0



ISO 4892-2A



Codice / Code

1732052414

Descrizione / Description

DES PM 24/14 G

Rev.  
004

Materiale / Material

TPE

Colore / Color

Grey

Peso / Weight (g)

-

Unità di misura / Measure units

mm

Formato / Format

A4

Scala / Scale

1:1

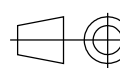

UNI-ISO  
2768-mk



www.detasultra.com

Data / Date  
10/12/2021

Numero foglio / Sheet number

-

Numero progetto / Project number

-

Disegn. / Drawn

ravezzano@detas.com

Note / Notes

-

QUESTO DISEGNO E LE SUE INFORMAZIONI SONO STRETTAMENTE RISERVATE DI PROPRIETA' DETAS SPA.  
NON UTILIZZARE PER SCOPI DIVERSI DA QUELLI PER CUI SONO STATE FORNITE. DO NOT SCALE DRAWING.

A

B

C

D

A

B

C

D

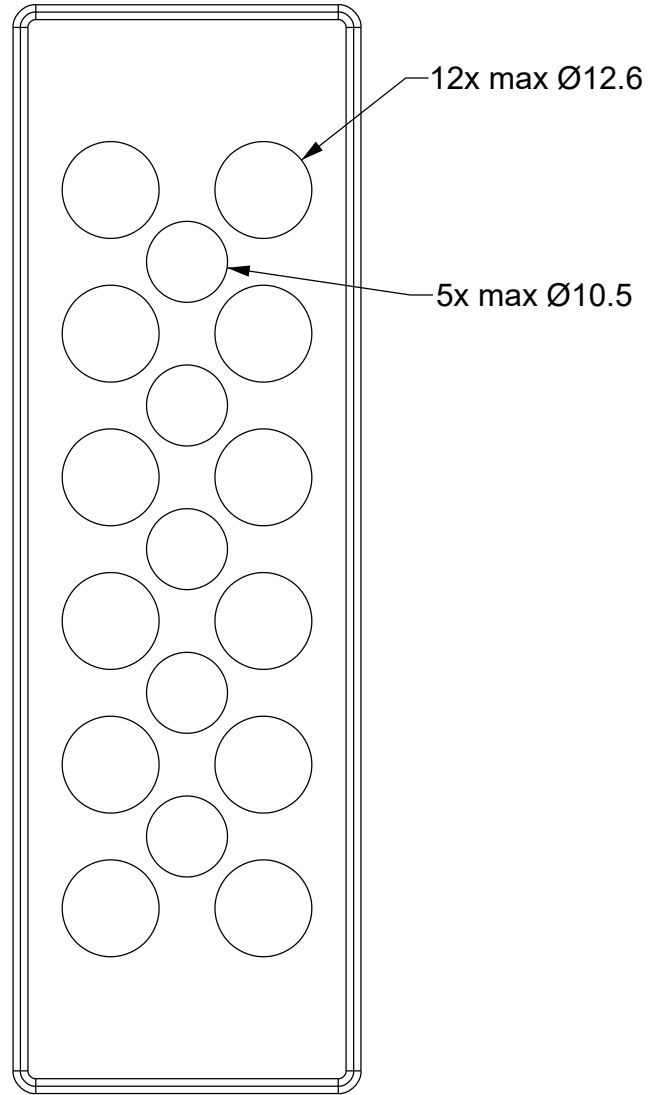
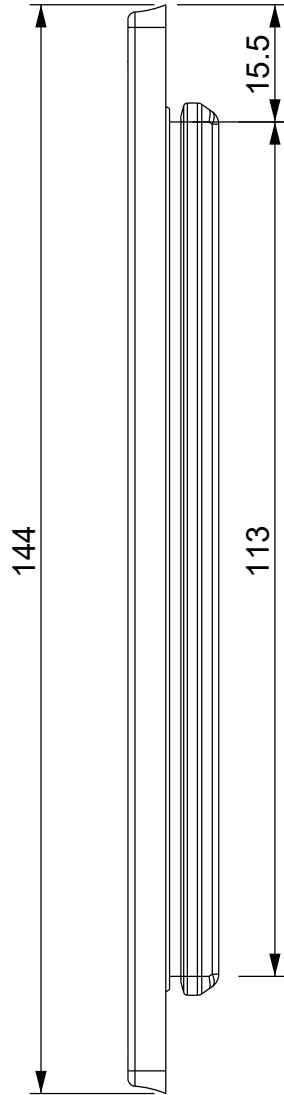
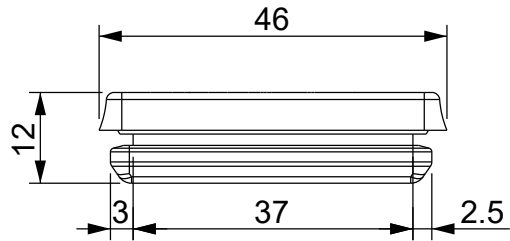
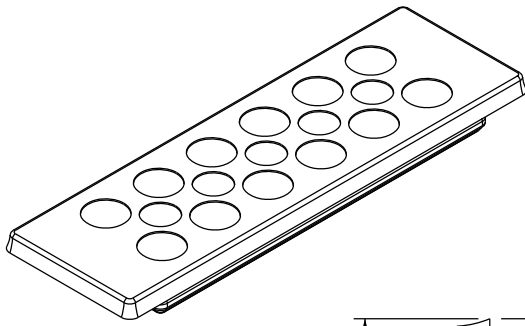

BLACK color version:  
DES PM 24/17B 1732053418

Wall thickness: 1.5 - 2.5 mm

**Flammability:** UL94-V0, self-extinguishing  
**Temperature:** -40°C ... +105°C  
**Properties:** halogen-free, silicone-free  
**Material:** thermoplastic elastomer (TPE)

Recommended cut-out:  
112 x 36 mm

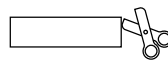

IP65

NEMA  
12

UL TYPE  
12



ECOLAB



UL94-V0



UV  
ISO 4892-2A



RoHS  
COMPLIANT

Codice / Code

1732052417

Descrizione / Description

DES PM 24/17 G

Rev.  
004

Materiale / Material

TPE

Colore / Color

Grey

Peso / Weight (g)

-

Unità di misura / Measure units

mm

Formato / Format

A4

Scala / Scale

1:1

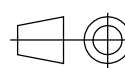

UNI-ISO  
2768-mk



Data / Date  
10/12/2021

Numero foglio / Sheet number

-

Numero progetto / Project number

-

Disegn. / Drawn  
ravezzano@detas.com

Note / Notes

-

QUESTO DISEGNO E LE SUE INFORMAZIONI SONO STRETTAMENTE RISERVATE DI PROPRIETA' DETAS SPA.  
NON UTILIZZARE PER SCOPI DIVERSI DA QUELLI PER CUI SONO STATE FORNITE. DO NOT SCALE DRAWING.

A

B

C

D

A

B

C

D

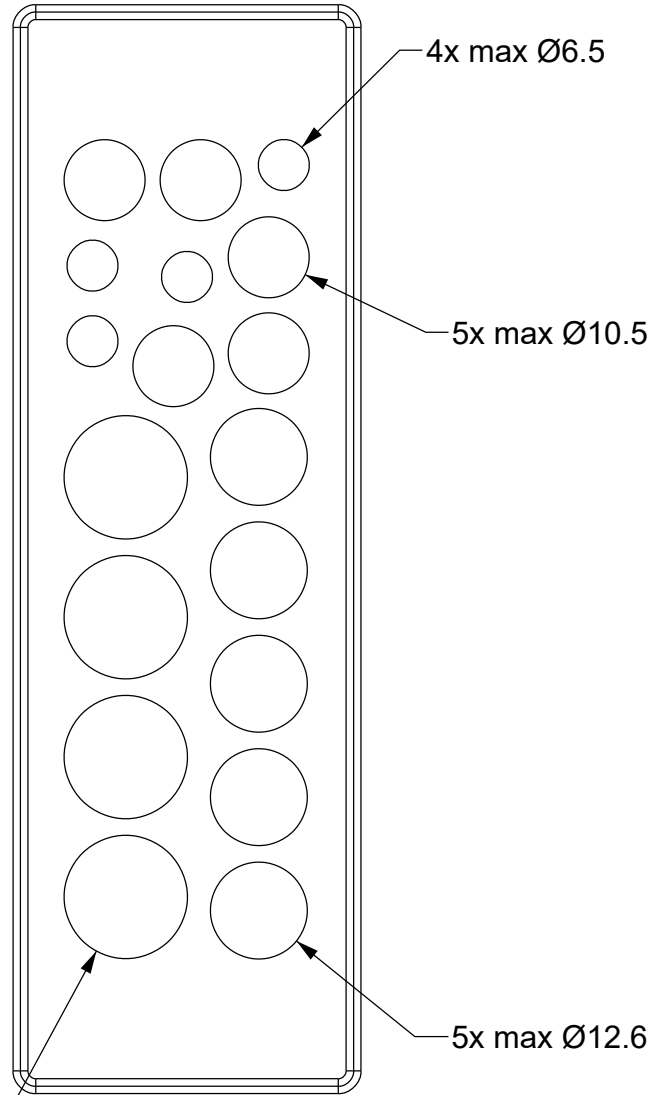
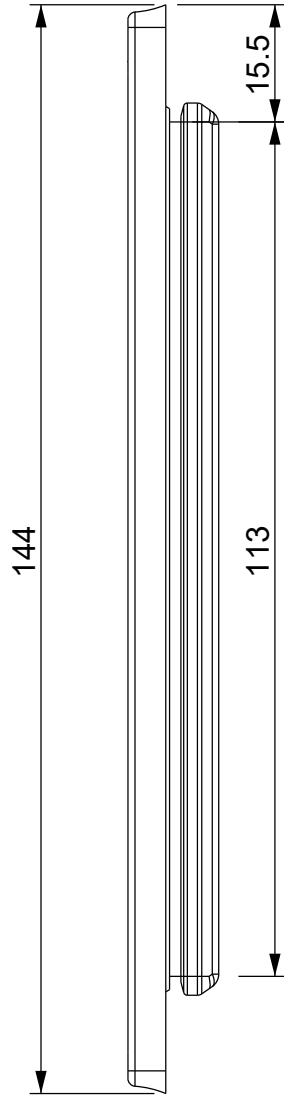
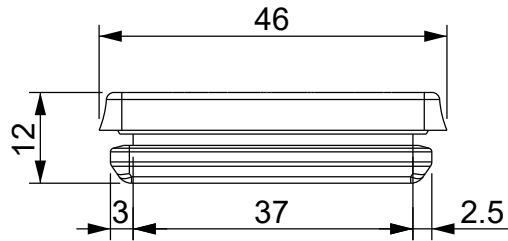
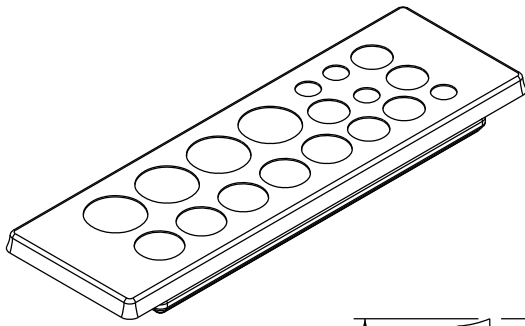

4x max Ø16.1

BLACK color version:

DES PM 24/18B 1732053419

Wall thickness: 1.5 - 2.5 mm

**Flammability:** UL94-V0, self-extinguishing  
**Temperature:** -40°C ... +105°C  
**Properties:** halogen-free, silicone-free  
**Material:** thermoplastic elastomer (TPE)

Recommended cut-out:  
112 x 36 mm

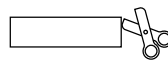

IP65

NEMA  
12UL TYPE  
12

ECOLAB



Codice / Code

1732052418

Descrizione / Description

DES PM 24/18 G

Rev.  
004

Materiale / Material

TPE

Colore / Color

Grey

Peso / Weight (g)

-

Unità di misura / Measure units

mm

Formato / Format

A4

Scala / Scale

1:1

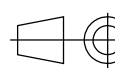
UNI-ISO  
2768-mkData / Date  
10/12/2021

Numero foglio / Sheet number

-

Numero progetto / Project number

-

Disegn. / Drawn

ravezzano@detas.com

Note / Notes

-

QUESTO DISEGNO E LE SUE INFORMAZIONI SONO STRETTAMENTE RISERVATE DI PROPRIETA' DETAS SPA.  
 NON UTILIZZARE PER SCOPI DIVERSI DA QUELLI PER CUI SONO STATE FORNITE. DO NOT SCALE DRAWING.

A

B

C

D

A

B

C

D

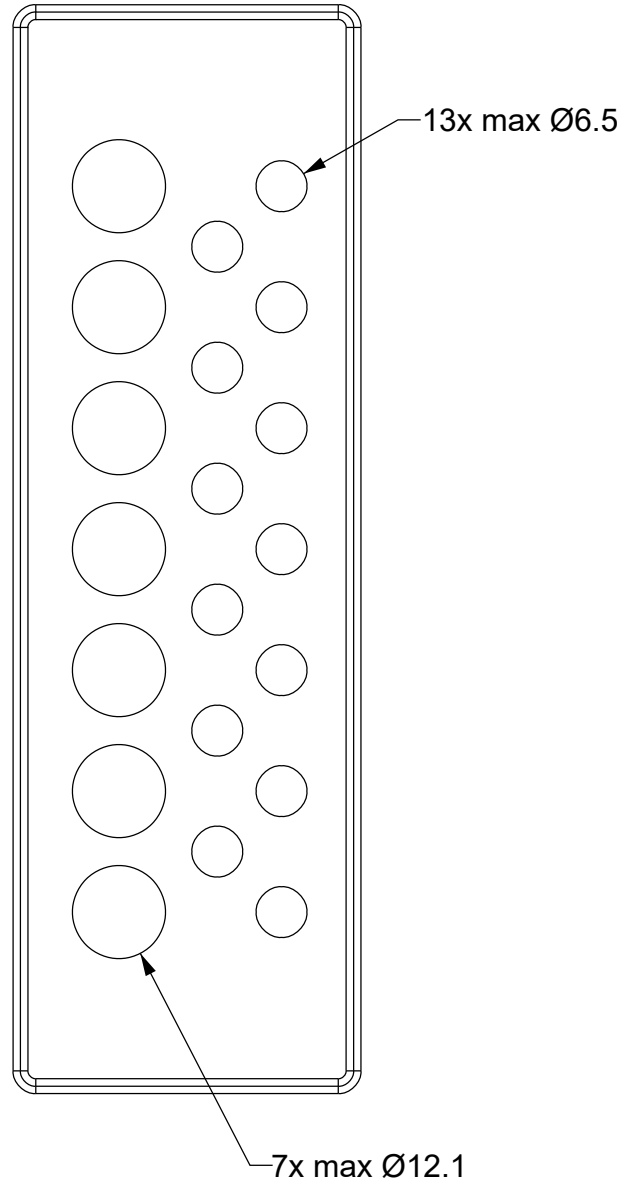
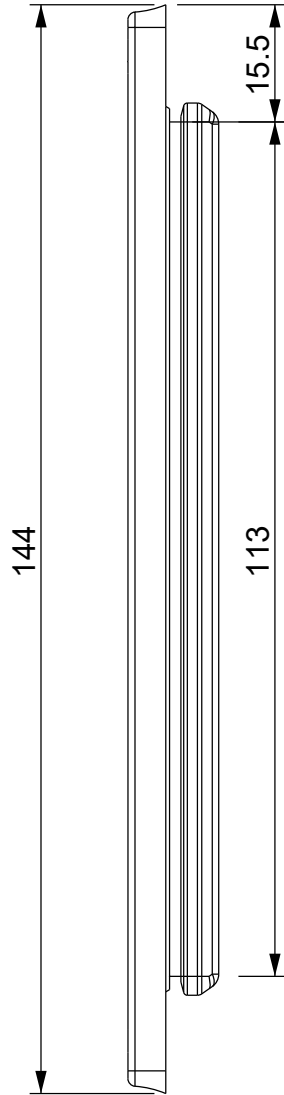
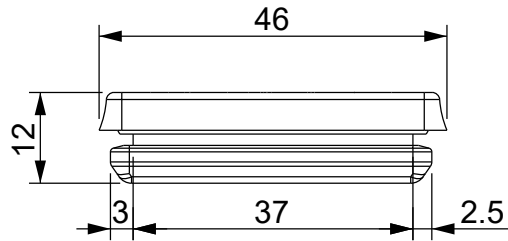
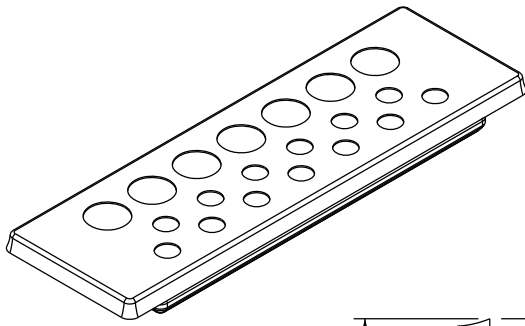

BLACK color version:  
DES PM 24/20B 1732053421

Wall thickness: 1.5 - 2.5 mm

**Flammability:** UL94-V0, self-extinguishing  
**Temperature:** -40°C ... +105°C  
**Properties:** halogen-free, silicone-free  
**Material:** thermoplastic elastomer (TPE)

Recommended cut-out:  
112 x 36 mm

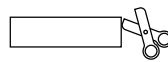

IP65

NEMA  
12

UL TYPE  
12



UL94-V0



ISO 4892-2A



Codice / Code

1732052420

Descrizione / Description

DES PM 24/20 G

Rev.  
004

Materiale / Material

TPE

Colore / Color

Grey

Peso / Weight (g)

-

Unità di misura / Measure units

mm

Formato / Format

A4

Scala / Scale

1:1

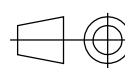

UNI-ISO  
2768-mk



Data / Date  
10/12/2021

Numero foglio / Sheet number

-

Numero progetto / Project number

-

Disegn. / Drawn  
ravezzano@detas.com

Note / Notes

-

QUESTO DISEGNO E LE SUE INFORMAZIONI SONO STRETTAMENTE RISERVATE DI PROPRIETA' DETAS SPA. NON UTILIZZARE PER SCOPI DIVERSI DA QUELLI PER CUI SONO STATE FORNITE. DO NOT SCALE DRAWING.

A

B

C

D

A

B

C

D

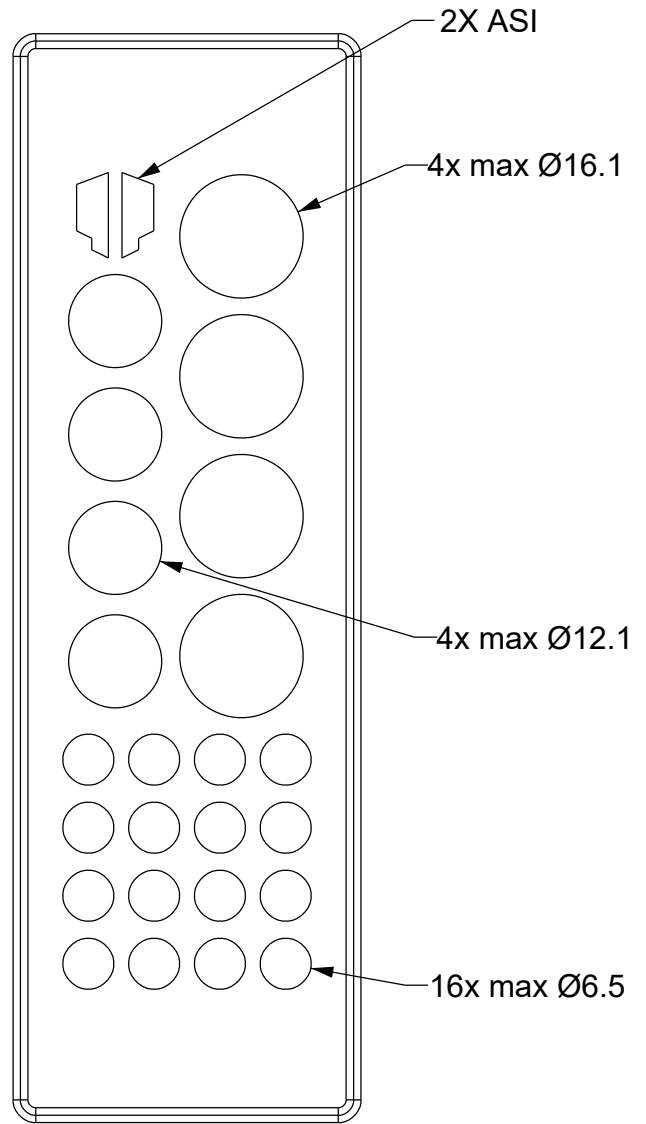
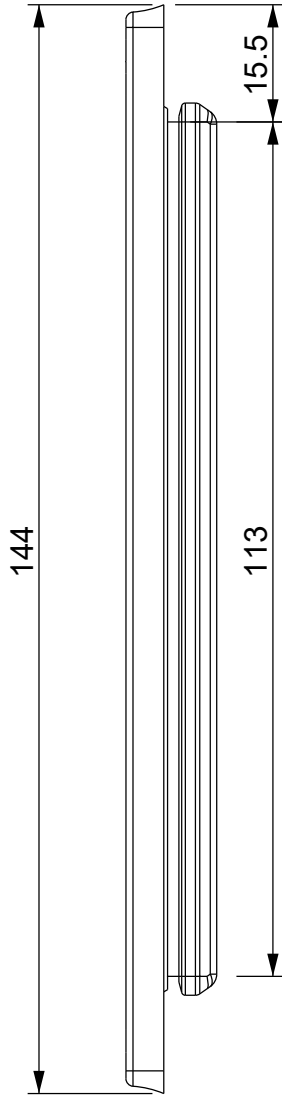
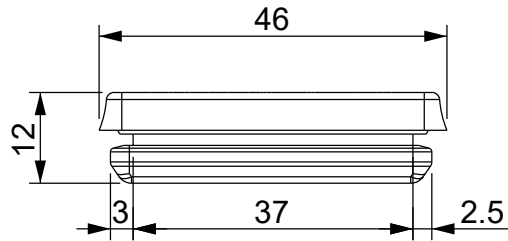
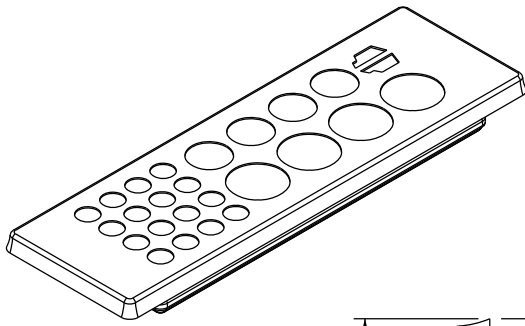

BLACK color version:  
DES PM 24/26B 1732053427

Wall thickness: 1.5 - 2.5 mm

**Flammability:** UL94-V0, self-extinguishing  
**Temperature:** -40°C ... +105°C  
**Properties:** halogen-free, silicone-free  
**Material:** thermoplastic elastomer (TPE)

Recommended cut-out:  
112 x 36 mm

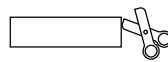

IP65

NEMA  
12

UL TYPE  
12



Codice / Code

1732052426

Descrizione / Description

DES PM 24/26 G

Rev.  
004

Materiale / Material

TPE

Colore / Color

Grey

Peso / Weight (g)

-

Unità di misura / Measure units

mm

Formato / Format

A4

Scala / Scale

1:1

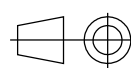

UNI-ISO  
2768-mk



Data / Date  
10/12/2021

Numero foglio / Sheet number

-

Numero progetto / Project number

-

Disegn. / Drawn  
ravezzano@detas.com

Note / Notes

-

QUESTO DISEGNO E LE SUE INFORMAZIONI SONO STRETTAMENTE RISERVATE DI PROPRIETA' DETAS SPA.  
NON UTILIZZARE PER SCOPI DIVERSI DA QUELLI PER CUI SONO STATE FORNITE. DO NOT SCALE DRAWING.

A

B

C

D

A

B

C

D

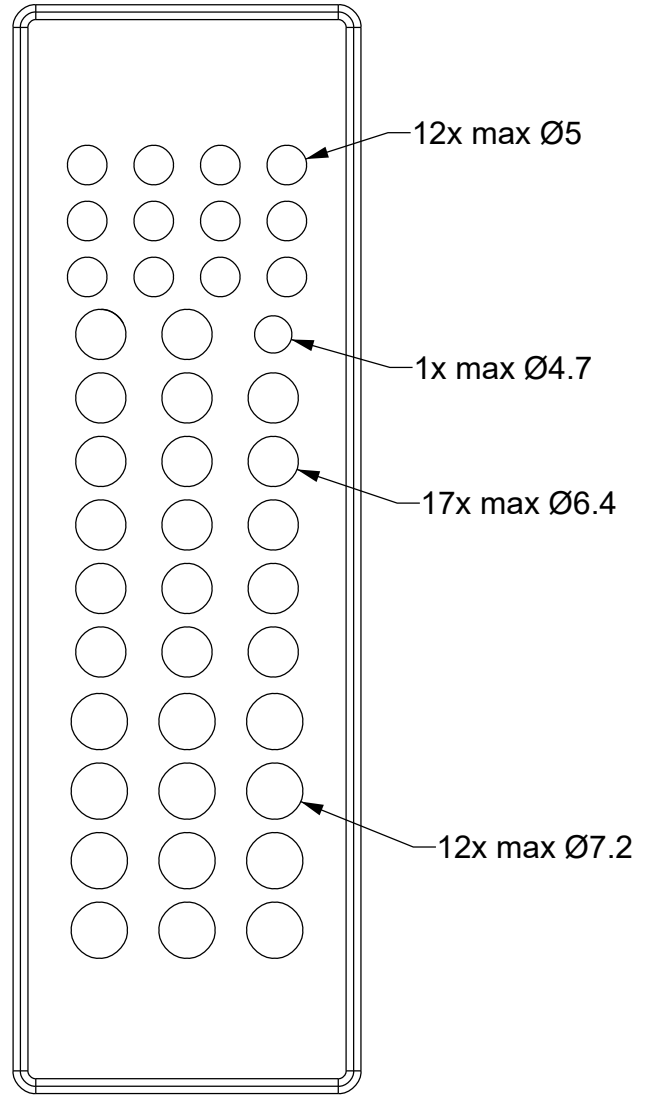
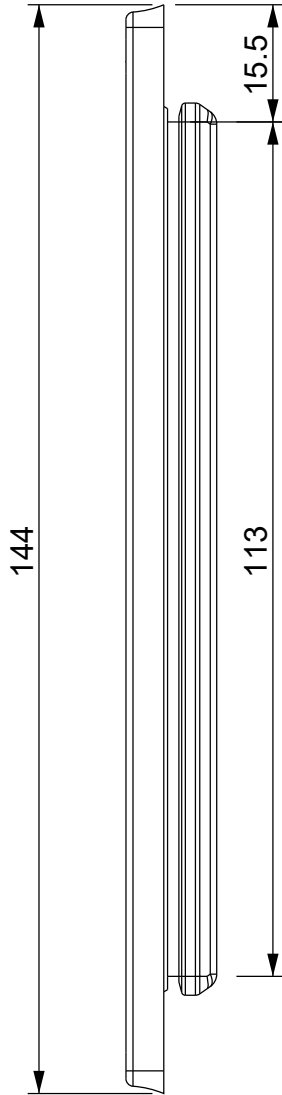
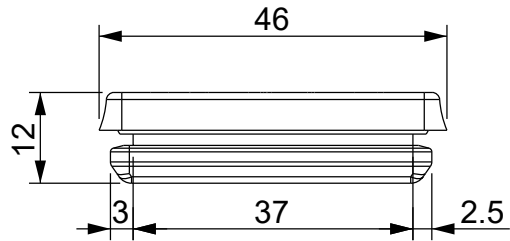
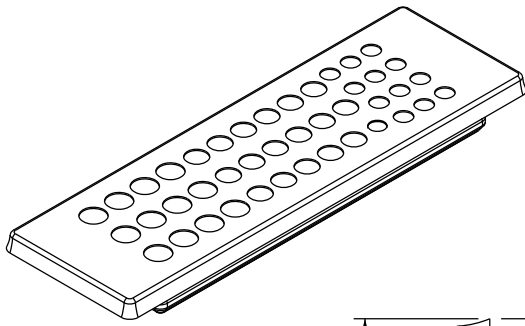

BLACK color version:  
DES PM 24/42B 1732053443

Wall thickness: 1.5 - 2.5 mm

**Flammability:** UL94-V0, self-extinguishing  
**Temperature:** -40°C ... +105°C  
**Properties:** halogen-free, silicone-free  
**Material:** thermoplastic elastomer (TPE)

Recommended cut-out:  
112 x 36 mm

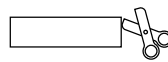

IP65

NEMA  
12

UL TYPE  
12



ECOLAB



UL94-V0



UV  
ISO 4892-2A



RoHS  
COMPLIANT

Codice / Code

1732052442

Descrizione / Description

DES PM 24/42 G

Rev.  
004

Materiale / Material

TPE

Colore / Color

Grey

Peso / Weight (g)

-

Unità di misura / Measure units

mm

Formato / Format

A4

Scala / Scale

1:1

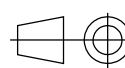

UNI-ISO  
2768-mk



Data / Date  
10/12/2021

Numero foglio / Sheet number

-

Numero progetto / Project number

-

Disegn. / Drawn  
ravezzano@detas.com

Note / Notes

-

QUESTO DISEGNO E LE SUE INFORMAZIONI SONO STRETTAMENTE RISERVATE DI PROPRIETA' DETAS SPA.  
NON UTILIZZARE PER SCOPI DIVERSI DA QUELLI PER CUI SONO STATE FORNITE. DO NOT SCALE DRAWING.

A

B

C

D

A

B

C

D

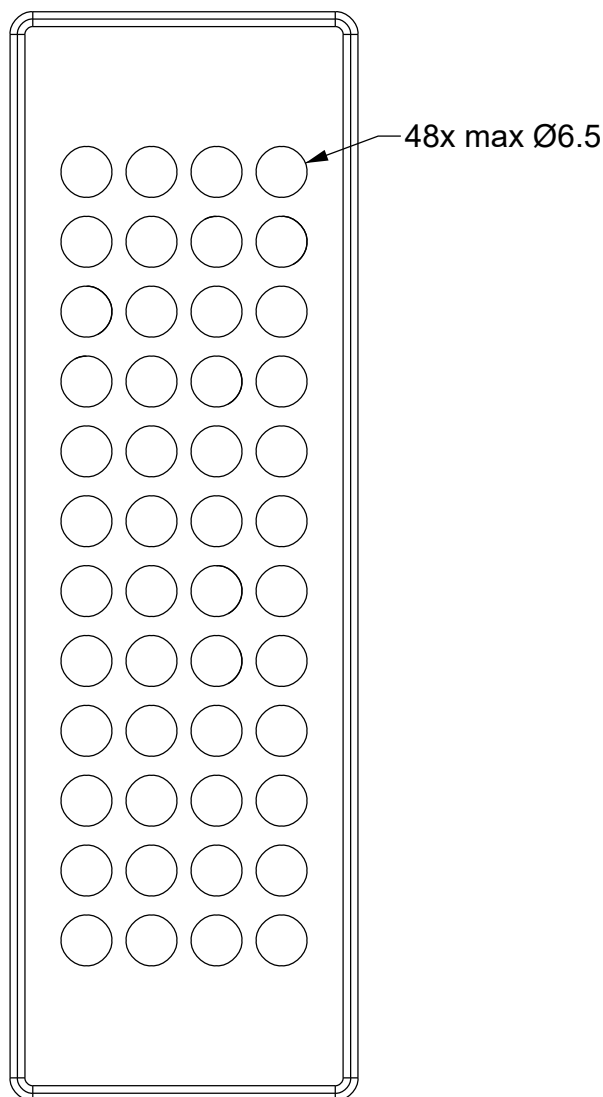
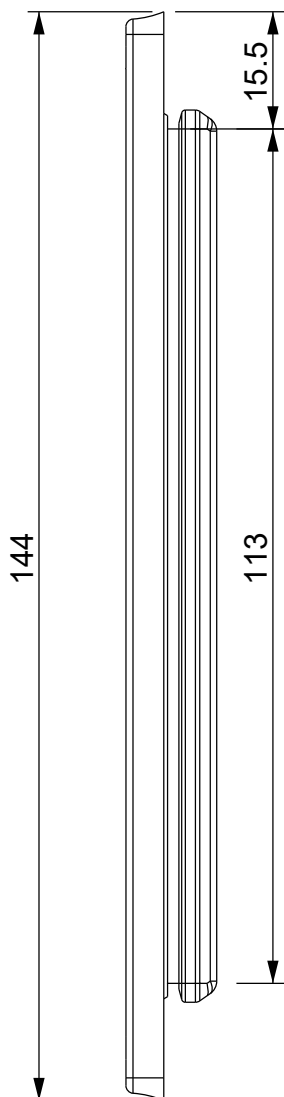
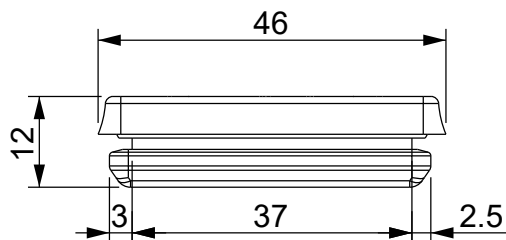
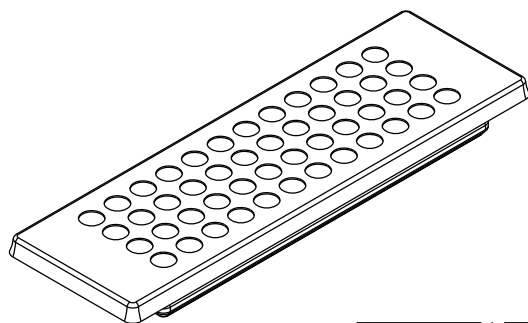

BLACK color version:  
DES PM 24/48B 1732053449

Wall thickness: 1.5 - 2.5 mm

**Flammability:** UL94-V0, self-extinguishing  
**Temperature:** -40°C ... +105°C  
**Properties:** halogen-free, silicone-free  
**Material:** thermoplastic elastomer (TPE)

Recommended cut-out:  
112 x 36 mm

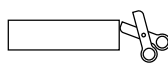

IP65

NEMA  
12

UL TYPE  
12



ECOLAB



UL94-V0



UV  
ISO 4892-2A



RoHS  
COMPLIANT

Codice / Code

1732052448

Descrizione / Description

DES PM 24/48 G

Rev.

004

Materiale / Material

TPE

Colore / Color

Grey

Peso / Weight (g)

-

Unità di misura / Measure units

mm

Formato / Format

A4

Scala / Scale

1:1

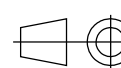

UNI-ISO  
2768-mk



www.detasultra.com

Data / Date

10/12/2021

Numero foglio / Sheet number

-

Numero progetto / Project number

-

Disegn. / Drawn

ravezzano@detas.com

Note / Notes

-

QUESTO DISEGNO E LE SUE INFORMAZIONI SONO STRETTAMENTE RISERVATE DI PROPRIETA' DETAS SPA.  
NON UTILIZZARE PER SCOPI DIVERSI DA QUELLI PER CUI SONO STATE FORNITE. DO NOT SCALE DRAWING.

A

B

C

D



A

B

C

D

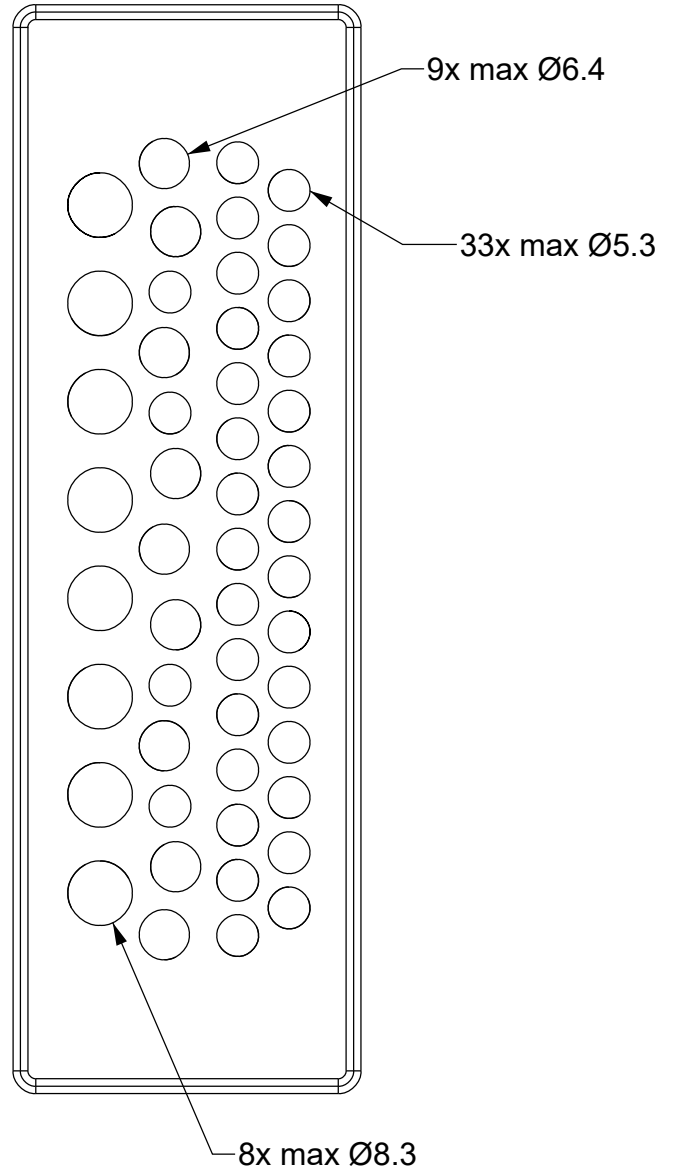
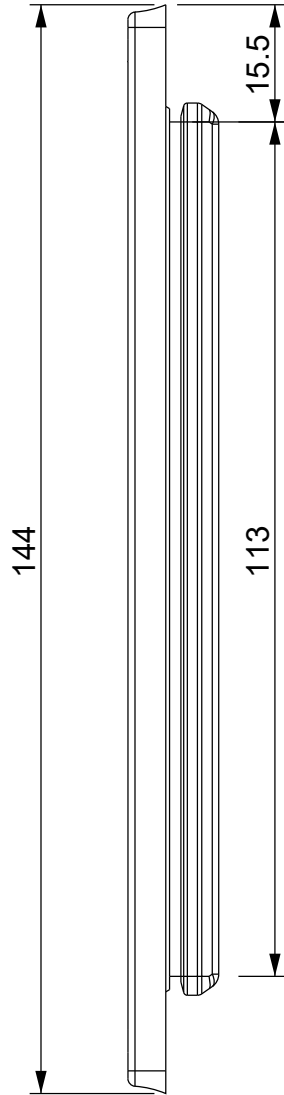
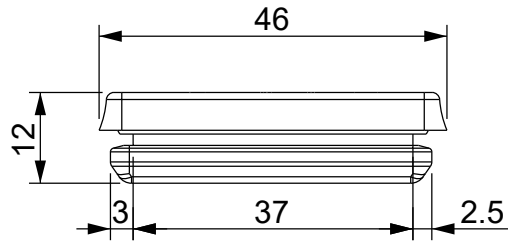
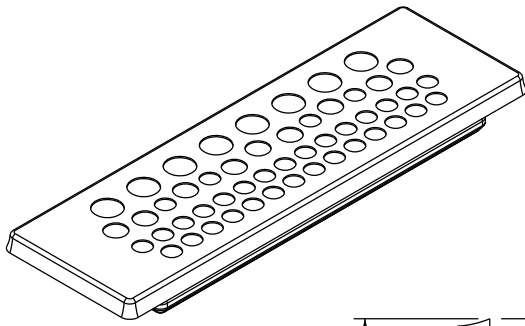

BLACK color version:  
DES PM 24/50B 1732053451

Wall thickness: 1.5 - 2.5 mm

**Flammability:** UL94-V0, self-extinguishing  
**Temperature:** -40°C ... +105°C  
**Properties:** halogen-free, silicone-free  
**Material:** thermoplastic elastomer (TPE)

Recommended cut-out:  
112 x 36 mm

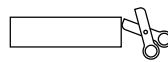

APPROVED  
UL US

IP65

NEMA  
12

UL TYPE  
12

APPROVED  
R  
MORSE TYPE

ECOLAB

UL94-V0

UV  
ISO 4892-2A

RoHS  
COMPLIANT

Codice / Code

1732052450

Descrizione / Description

DES PM 24/50 G

Rev.  
004

Materiale / Material

TPE

Colore / Color

Grey

Peso / Weight (g)

-

Unità di misura / Measure units

mm

Formato / Format

A4

Scala / Scale

1:1

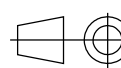

UNI-ISO  
2768-mk



Data / Date  
10/12/2021

Numero foglio / Sheet number

-

Numero progetto / Project number

-

Disegn. / Drawn  
ravezzano@detas.com

Note / Notes

-

QUESTO DISEGNO E LE SUE INFORMAZIONI SONO STRETTAMENTE RISERVATE DI PROPRIETA' DETAS SPA.  
NON UTILIZZARE PER SCOPI DIVERSI DA QUELLI PER CUI SONO STATE FORNITE. DO NOT SCALE DRAWING.

A

B

C

D