



T Piece
IP68



BETR

PMA Ex eb Non Metallic System

Dimensions

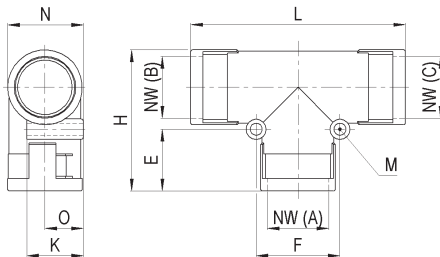

Features

- Made of dissipative PA12
- Prevents electrostatic charging
- For indoor and outdoor applications
- High system connection strengths
- Easy installation
- Very good chemical properties

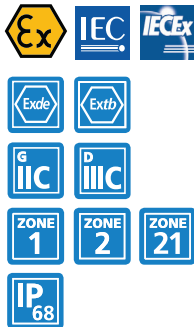

Certification & Standards

Approved to:	IEC EN 60079-0, 60079-7, 60079-31
EC TYPE Examination	ATEX: SEV 15 ATEX 0121X
Certificate:	IECEX: IECEX SEV15.0009X Ex eb IIC Gb Ex tb IIIC Db
Temperature:	-5°C to +85°C Sizes 02-03 (NW10-12) -20°C to +85°C Sizes 04-08 (NW17-48)
IP protection:	IP68

order no.	conduit size			dimensions in mm (nom.)							weight kg/100 pcs	packing unit PU/pcs	
	A	B	C	E	F	H	K	L	M	N			O
black													
BETR020202	10	10	10	19.0	21.0	39.5	16.0	59.0	2xM4	21.0	10.5	1.5	10
BETR030303	12	12	12	22.5	26.5	47.5	18.5	71.5	2xM4	24.0	12.0	1.7	10
BETR040404	17	17	17	29.5	34.0	61.5	22.0	93.5	2xM5	30.0	15.0	3.2	10
BETR050505	23	23	23	30.5	41.5	70.0	28.0	106.5	2xM5	37.5	19.0	5.5	10
BETR060606	29	29	29	31.5	48.0	77.5	32.5	111.0	2xM5	44.5	22.5	6.5	10
BETR070707	36	36	36	44.0	57.0	99.0	40.0	150.5	2xM6	54.5	27.5	12.0	10
BETR080808	48	48	48	43.0	71.0	111.5	47.5	163.0	2xM6	66.5	33.5	18.5	10

Our customer service dept. or local distribution partner will be pleased to help you concerning product availability and lead time



T Piece
IP68



BETR

PMA Ex eb Non Metallic System

properties	unit	value	test method
Mechanical properties			
Stress-E-module	N/mm ²	350	ISO 527
Tensile strength	N/mm ²	35	ISO 527
Notched bar impact test	kJ/m ²	9 (-30°C)	ISO 179/2-1eA
Impact strength	kJ/m ²	> 7 (85°C)	EN 60079-0
	kJ/m ²	> 7 (-20°C)	EN 60079-0
Thermal properties			
For use in hazardous locations:			
Temperature range sizes 02-03	°C	-05 ... +85	EN 60079-0
Temperature range sizes 04-08	°C	-20 ... +85	EN 60079-0
General:		-50 ... +95	
Fire safety characteristics			
Application approvals			
System test			
Please refer to Info-No. 10			
Electrical properties			
Specific surface resistivity	Ω	< 10 ⁷	ASTM D257
Chemical properties			
Please refer to www.pma.ch			
Environmental properties			
RoHS and REACH compliant		yes	EU Directive 2011/65/EU EU Directive 1907/2006/EC
Weathering resistance			
Weathering (UV/humidity) for black colour		very good	
Content of delivery			
T piece with clips (OVN2), Ex-System conduit seals (NEN3)			
Mounting indication			
Assembly instructions and other relevant documents are available at www.pma.ch .			

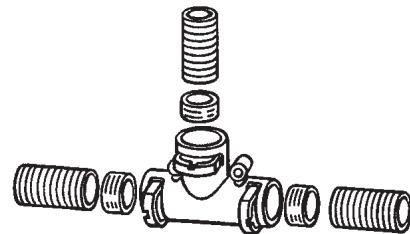

The specifications and instructions for our customers in this document reflect the product engineering level at the time of manufacturing. Please consider the valid data sheet release at a time. For questions please contact the PMA customer service. ABB Switzerland, PMA Cable Protection accepts no liability for damages resulting from unprofessional installation or application or misuse for a purpose. This disclaimer also includes damages to third parties. It is the customer's responsibility to check the delivered products and immediately notify ABB Switzerland, PMA Cable Protection of detected faults. It is also the customer's responsibility to test the delivered product on its applicability for the intended purpose. ABB Switzerland, PMA Cable Protection will accept no liability or responsibility for their products if a product or a PMA system is combined or used together with third-party products, i.e. products from other companies than ABB Switzerland, PMA Cable Protection. Jurisdiction in all legal disputes concerning product liability have the courts of the canton of Zurich/Switzerland. Swiss law applies.

For more information and the newest data sheet releases go to: www.pma.ch